













### Legenda

-  Perimetro P.I.P. vigente
-  ART. 21: aree per insediamenti produttivi con If=0,60 mq/mq
-  ART. 21: aree per insediamenti produttivi con If=1,00 mq/mq
-  ART. 26: area standard
-  ART. 26: area standard - attività riservate al nodo interscambio ed alle infrastrutture logistiche e tecnologiche
-  ART. 26: area standard - verde
-  ART. 26: area standard non computabili ai fini dei minimi di legge
-  ART. 29: protezioni stradali
-  ART. 31: aree per infrastrutture ferroviarie
-  ART. 30: protezioni di infrastrutture idrovie e idrauliche
-  ART. 21: aree per insediamenti produttivi con If=0,60 mq/mq, fascia di 30 m di salvaguardia ferroviaria
-  Elettrودotto



### Planimetria stato di fatto Scala 1:5000

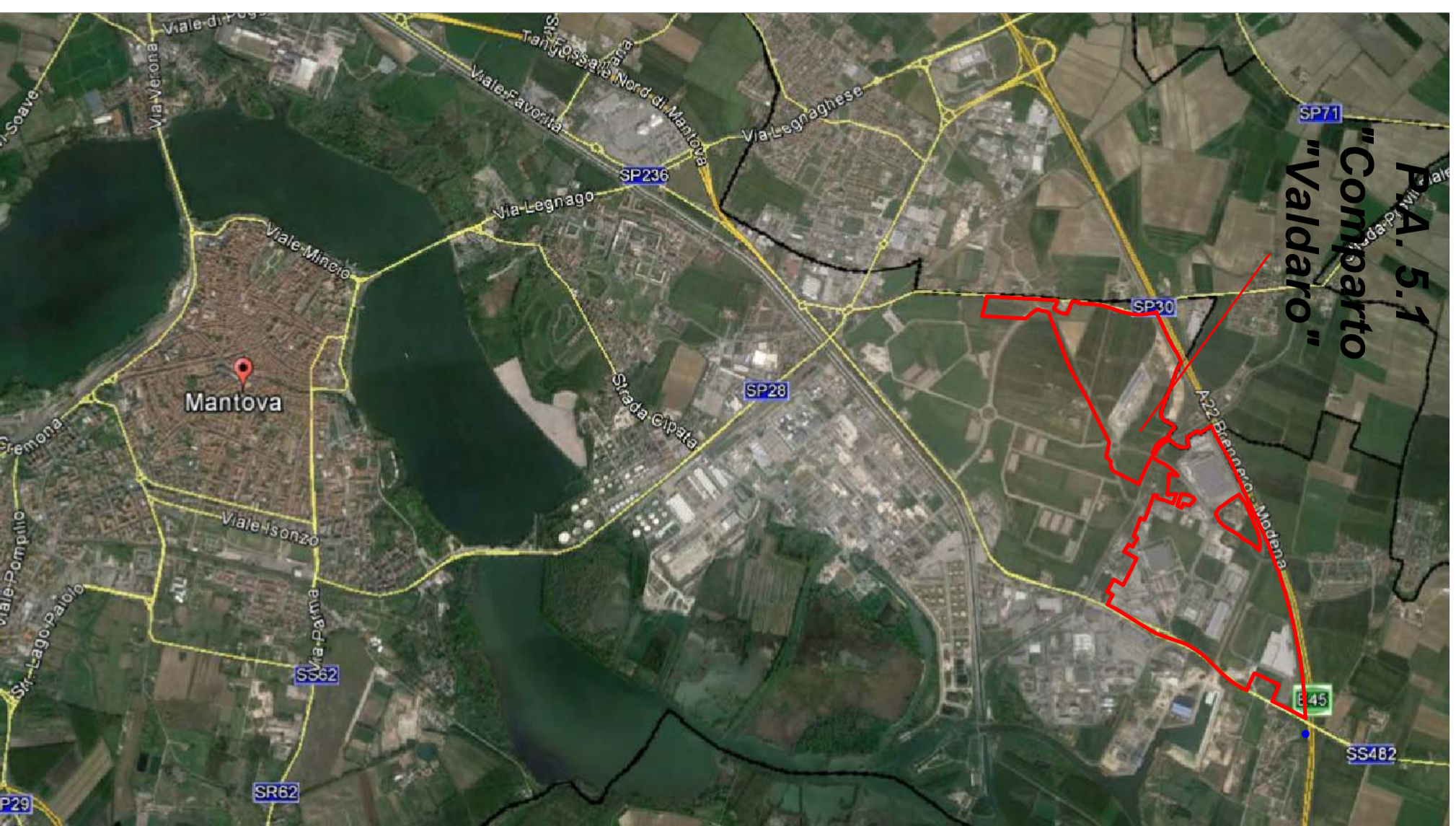
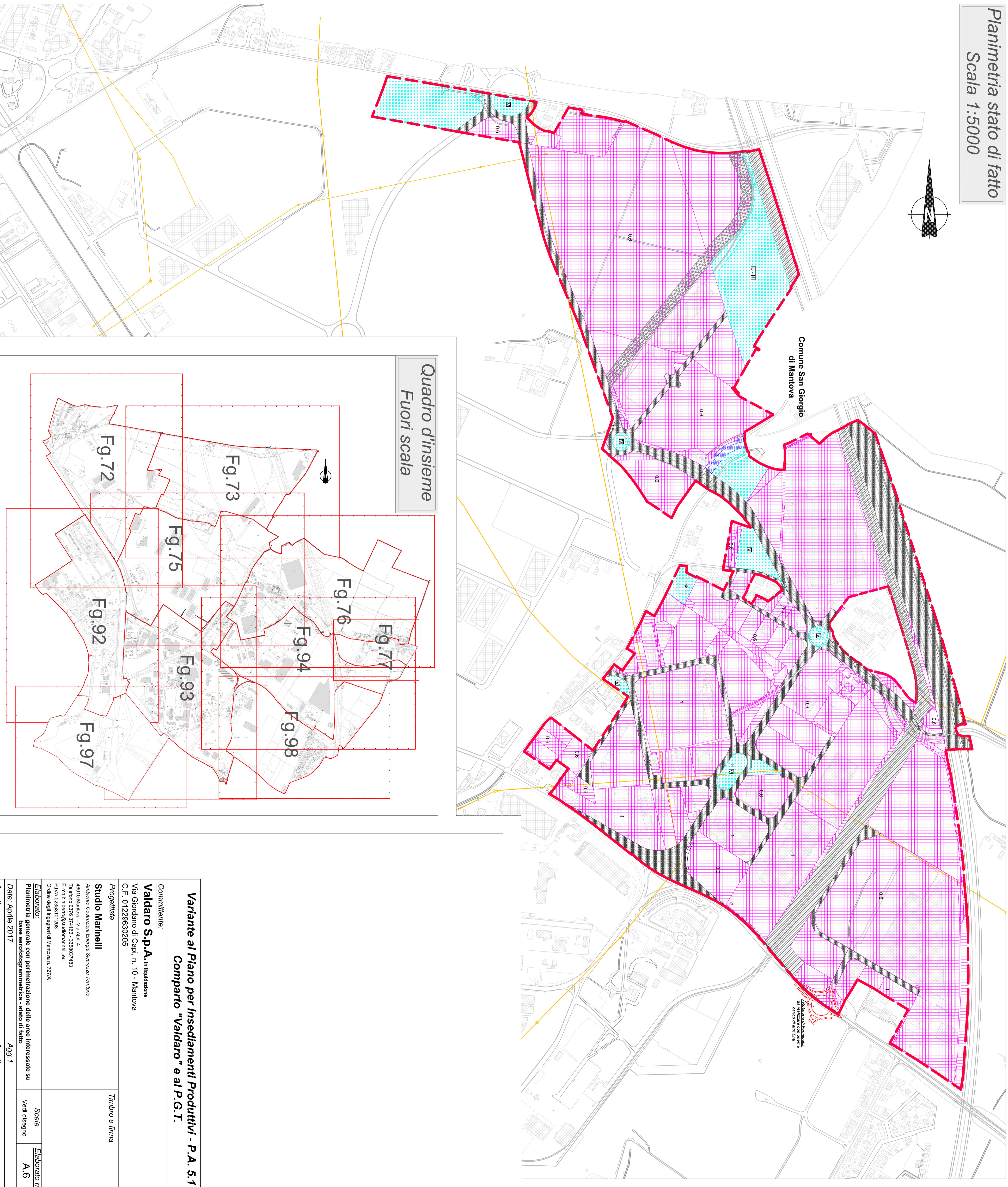

### Quadro d'insieme Fuori scala

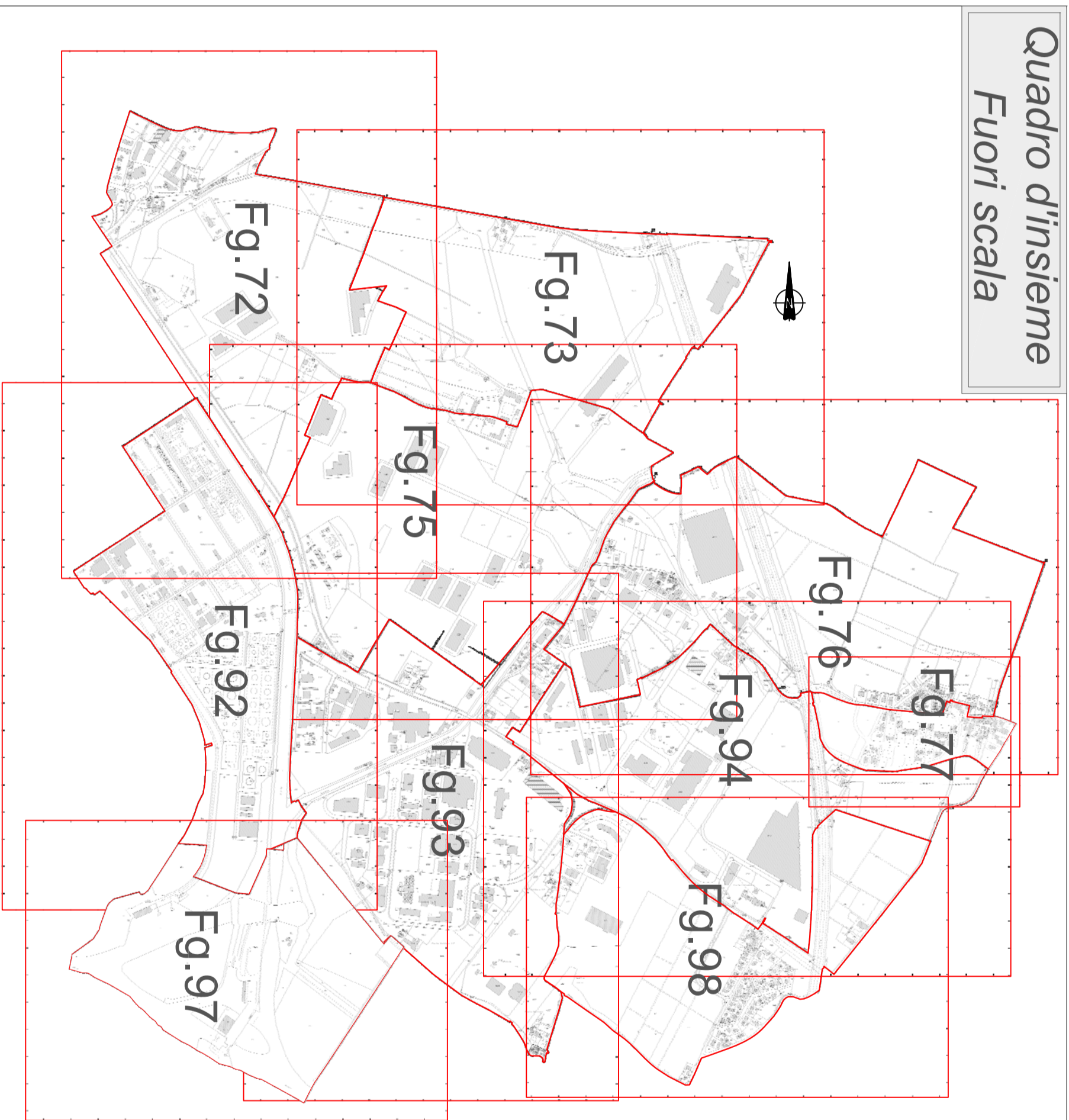

### Variante al Piano per Insediamenti Produttivi - P.A. 5.1 Comparto "Valdaro" e al P.G.T.

**Committente:**  
Valdaro S.p.A. in liquidazione  
Via Giordano di Capri, n. 10 - Mantova  
C.F. 0129830205

**Progettista**

**Studio Marinelli**

Ambiente, Costruzioni, Energia, Sicurezza, Territorio  
46010 Mantova - Via Agli, 4  
Telefono 0376 374166 - 3388037483  
E-mail: [studio@studiomarinelli.eu](mailto:studio@studiomarinelli.eu)  
P.IVA 02588107026  
Per informazioni: [info@studiomarinelli.eu](mailto:info@studiomarinelli.eu)

Timbro e firma

**Elaborato n°**  
Planimetria generale con perimetrazione delle aree interessate su base aerofotogrammetrica - stato di fatto

Scala  
Vedi disegno  
Elaborato n°  
A.6

**Data:** Aprile 2017

**Agg. 2**

**Agg. 1**

**Agg. 3**

Disegno protetto a termini di legge